

## Oakgrove Adoption Status November 2025

Oakgrove is divided into phases for adoption as shown here.

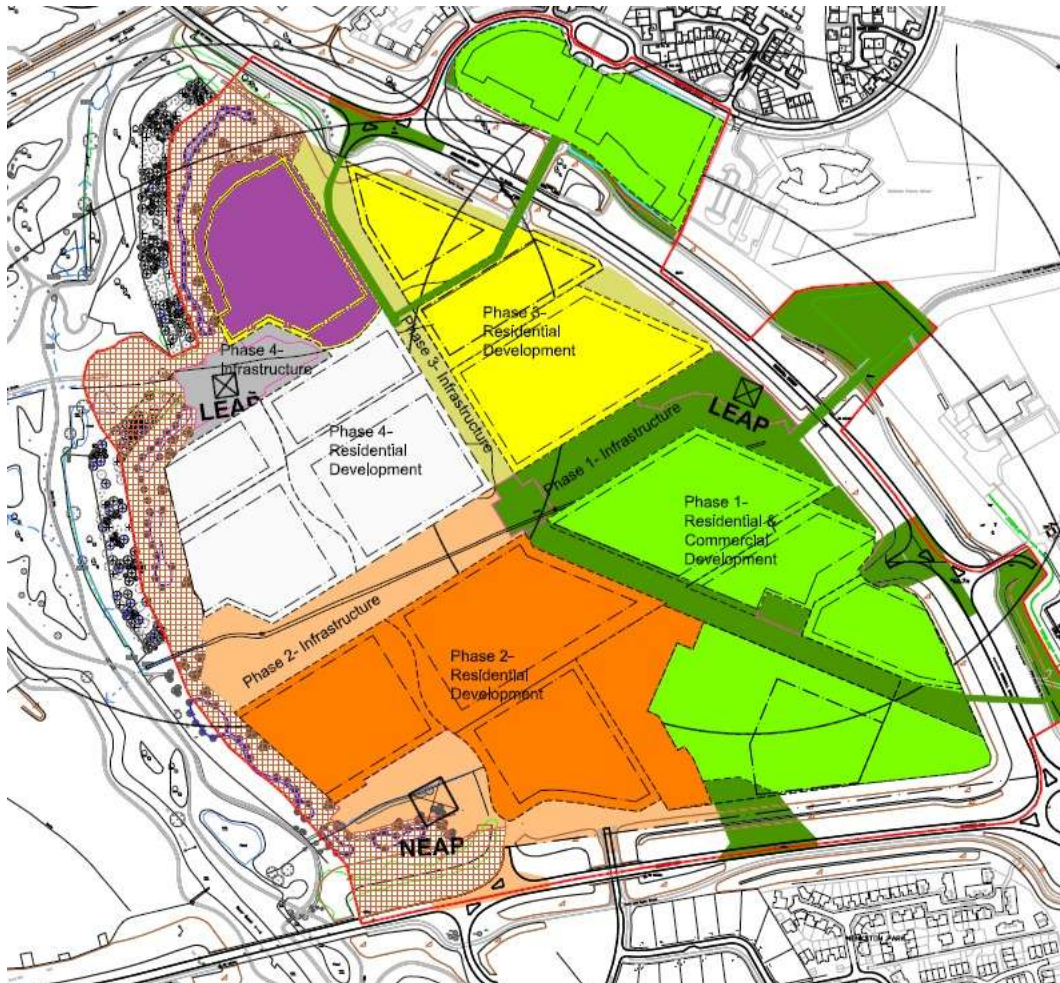

The whole estate was declared functionally complete some years ago – though there were some 150 remedials to be done – but there were problems with the sewers. That meant digging up the roads so they couldn't complete those either.

**Phase 1** in bright green, was adopted in full some time ago as the sewers in that area were OK.

The **phase 1 infrastructure**, shown in dark green, and the **phase 2 and 4 infrastructure**, shown in light orange, grey, and orange squares, were also adopted. They are the main stretch of Atlas Way and all the main green areas. All the green area around the edges of the grid square was already owned by MK Council and maintained by the Parks Trust.

The council maintain the roads, and the Parks Trust maintains all the greenery including highway verges. The school manage their land.

And then things stopped for years. However, it's finally progressing again.

**Phase 2:** the sewers and phase 2 streets and verges are being finished at present. They had hoped to finish by Christmas 2025, but there has been some delay.

**Phase 3** – yellow – and **phase 4** – white – will follow after that.

And then finally **phase 5** in purple.

### **Private Roads**

Some roads and parking areas are private and will be owned by their householders, not adopted by the Council. You can see which these are by using the “highway regulatory” option on the city map on the Council website. Blue means already adopted. Orange means adoption agreement in place but not yet adopted. White areas will remain private.